

# ELBA

Un sistema a lamelle orientabili fino a 140° ed una struttura 45° per l'installazione in configurazione a parete o ad isola, anche in moduli affiancati.

Le proprietà bioclimatiche del frangisole offrono un maggiore controllo sulla luce solare diretta e sul ricircolo d'aria. La potenza del motore lineare in dotazione standard permette inoltre di coprire superfici sempre più estese con un unico modulo.

Il telaio può essere dotato di illuminazione a led, per creare un'atmosfera rilassante e d'effetto.

**Certificazioni (EN 13659)**

**Resistenza al vento: Classe 5**

**Carico neve: 80 Kg/m<sup>2</sup>**

## SEZIONE LATERALE

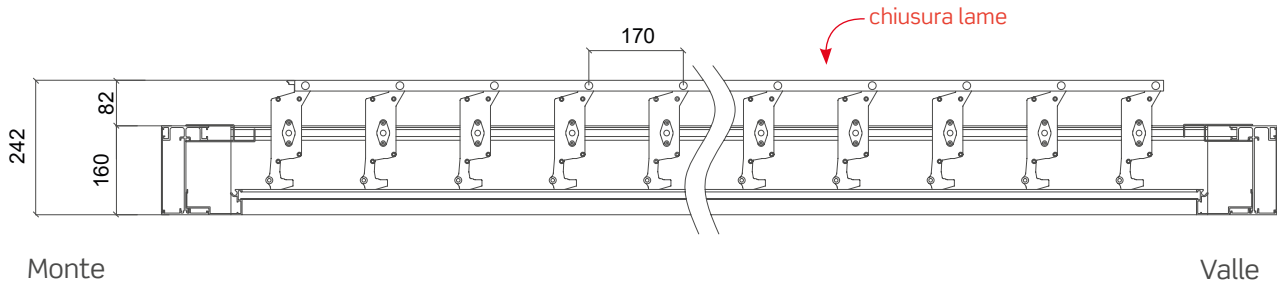

## Colorazione

Altri colori a preventivo

### DI SERIE

Bianco Ral 9010  
Avorio Ral 1013  
Ral 7016 SOFT

### SUPPLEMENTO 8%

Bianco SOFT/Opaco Ral 9010  
Avorio SOFT/Opaco Ral 1013  
Argento Ral 9006

## Informazioni tecniche

- Lamelle da 188,5 mm in alluminio verniciato
- Orientamento da 0° a 140°
- Viteria in acciaio Inox
- Comando a motore compreso di centralina e radiocomando
- Resistente agli agenti atmosferici
- Facile da installare

## Componenti Elba

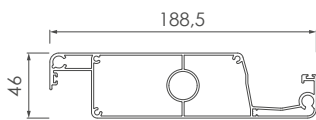

Lamella

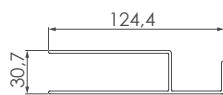

Compensatore

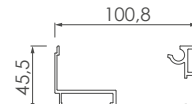

Gronda

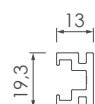

Profilo Guida

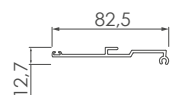

Paratia

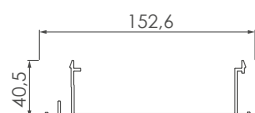

Cartellina strutturale

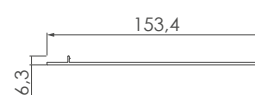

Cartellina

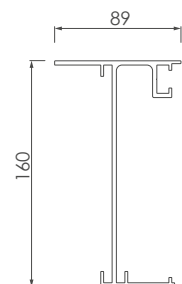

Telaio (mod. Patio)

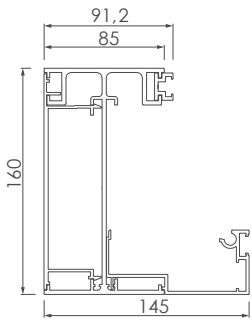

Montante

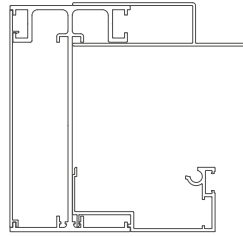

Traverso

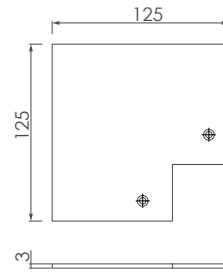

Tappo superiore

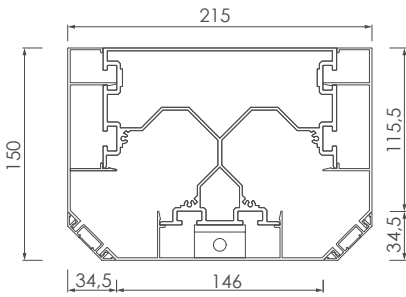

Piede centrale

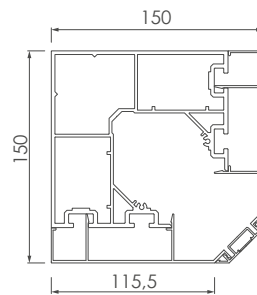

Piede laterale

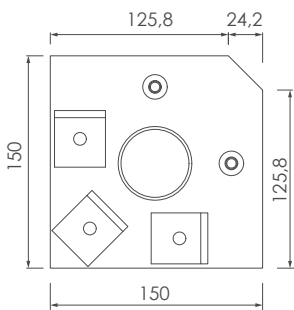
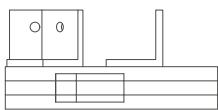

Piastra di fissaggio piede laterale

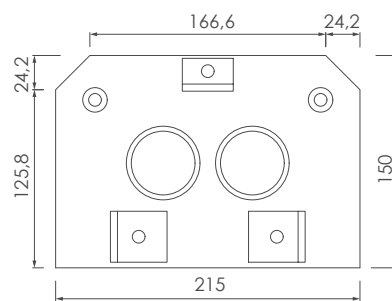
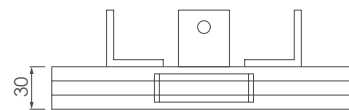

Piastra di fissaggio piede centrale